

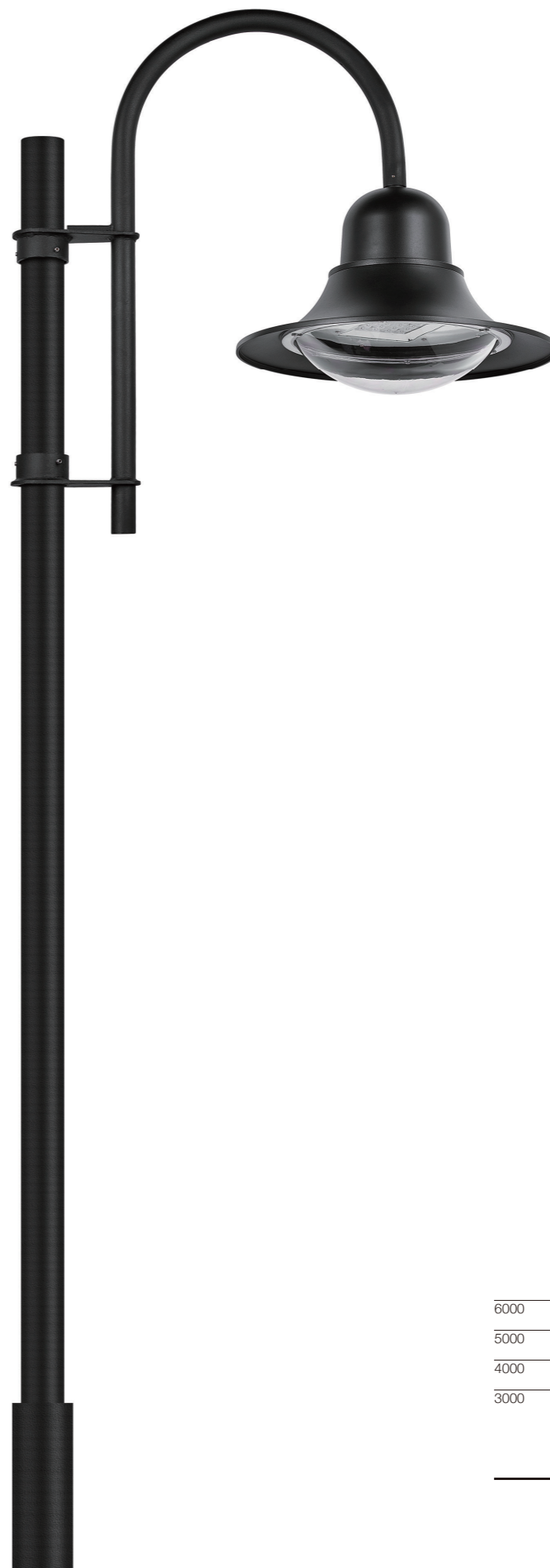

T-91

KLED



T-91
30-75W

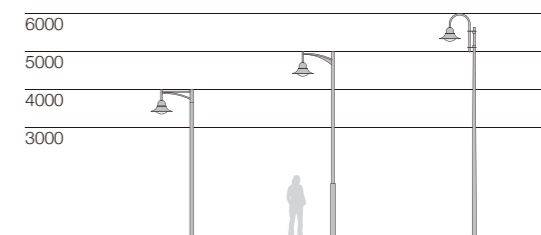

简述 Description



- 铝压铸灯体外壳, PC透明塑料罩, 镀铬塑料反射罩
- 高透光PC透镜, 具有高视觉舒适性和均匀配光透镜, 供多种不同配光选择
- 高性能LED芯片, 驱动有0-10V / DALI / 编程电源选择, 20KV浪涌保护器
- 灯具采用LED模组, 安装更换方便
- 防紫外线聚氨酯塑粉喷涂表面, 盐雾测试可以达1000小时以上
- 无生物蓝光危害风险, 符合EN62471: 2008标准
- 道路灯智能远程控制系统可选, 可以与远程管理系统兼容
- 所有外部螺钉均为304不锈钢材质



MD-09B LED Module



MD-09D LED Module

- Die-casting aluminium body, PC transparent diffuser, Chrome plastic reflector.
- Optics with PC lens with high visual comfortable and uniform lighting distribution, multiple light distribution options.
- High quality LED chips, Driver with 0-10V/DALI/programmed options, and with surge protection up to 20KV.
- LED module is used inside, which is easy to install and replace.
- Surface anti-ultraviolet pure polyester powder painting, Corrosion resistance can be more than 1000 hours.
- No photo-biological risk, (no risk linked to infrared, blue light and UV radiation) in accordance with EN 62471:2008.
- Street lighting control used with smart control technology. It can be compatible with remote management system.
- All external screws are made of 304 stainless steel.

技术参数 Technology data

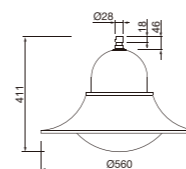

T-91

Code	Power	LED Qty	Optics	Packing Size	Weight	Pcs/20"	Pcs/40"
LED chips - 3535/5050							
T-91LED30-16	30W	16	T1/T2A/T3A/T4A	575*575*350	6.8	240	480
T-91LED40-16	40W	16	T1/T2A/T3A/T4A	575*575*350	6.8	240	480
T-91LED60-24	60W	24	T1/T2A/T3A/T4A	575*575*350	6.8	240	480
T-91LED75-36	75W	36	T1/T2A/T3A/T4A	575*575*350	6.8	240	480

LED chips - 3030

T-91LED40-56	40W	56	T1B/T2B/T3B/T4B	575*575*350	6.8	240	480
T-91LED60-84	60W	84	T1B/T2B/T3B/T4B	575*575*350	6.8	240	480

应用透镜 Optics application

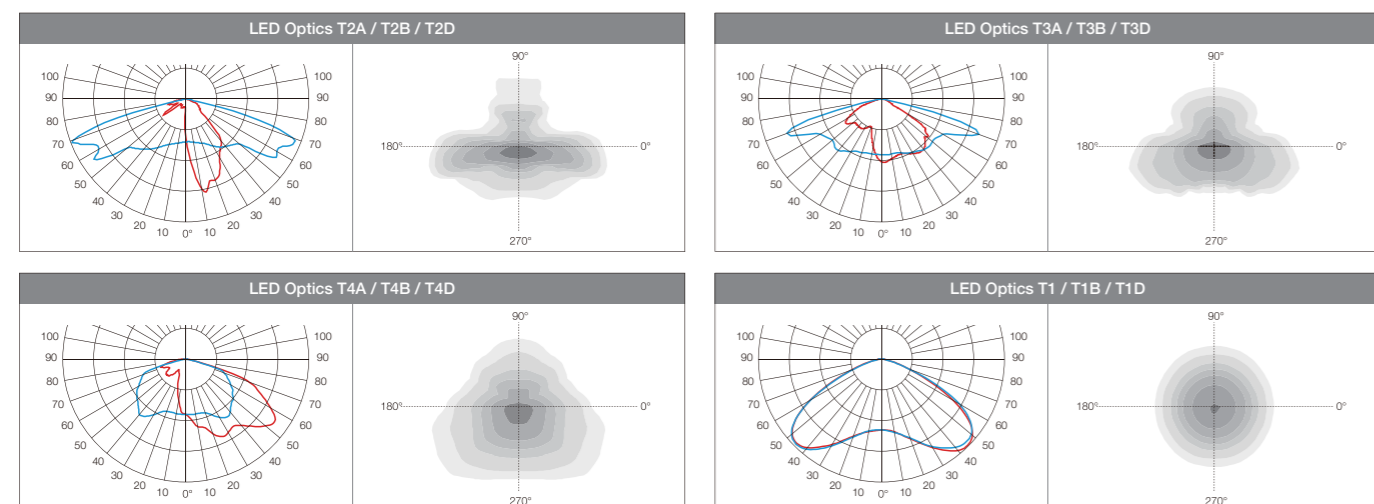

可选配件 Accessories options

	Code
防水连接器 IP68 Connector	32000047
吊装接头 Lifting Joint	250000101